

SERVING  
INDUSTRY for  
**50**  
years  
SINCE 1969

# HYDRAULIC EXCAVATOR PARTS & SERVICES

- CATERPILLAR/BUCYRUS/TEREX/O&K
- HITACHI • KOMATSU • LIEBHERR

Hofmann Engineering offers a wide range of product improved replacement parts interchangeable with O&K, Terex, Bucyrus, Caterpillar, Liebherr, Hitachi & Komatsu Hydraulic Excavators. Major components include sticks, booms, side frames, all transmissions (swing & propel), complete undercarriages and slew bearings.



## LIEBHERR

- Product improved propel and swing drives for R996B.
- New, overhauled or service exchange gearboxes.
- Like for like replacement internal gearing or upgraded internal gearing with the latest technology in case hardening by carburising or induction hardening and high precision grinding to DIN 5/AGMA 12 (min).
- Full gear quality inspection on all gearing using the latest gear inspection technology.
- Test run prior to despatch.



## HITACHI

- Product improved propel and swing drives for EX3600/5500.
- New, overhauled or service exchange gearboxes.
- Like for like replacement internal gearing or upgraded internal gearing with the latest technology in case hardening by carburising or induction hardening and high precision grinding to DIN 5/AGMA 12 (min).
- Full gear quality inspection on all gearing using the latest gear inspection technology.
- Test run prior to despatch.



## CATERPILLAR/BUCYRUS /TEREX/O&K

- Product improved propel and swing drives for RH120 / RH170 / RH200 / RH340 / RH400.
- New, overhauled or service exchange gearboxes.
- Like for like replacement internal gearing or upgraded internal gearing with the latest technology in case hardening by carburising or induction hardening and high precision grinding to DIN 5/AGMA 12 (min).
- Full gear quality inspection on all gearing using the latest gear inspection technology.
- Test run prior to despatch.

©Copyright 2019, Hofmann Engineering Pty Ltd.

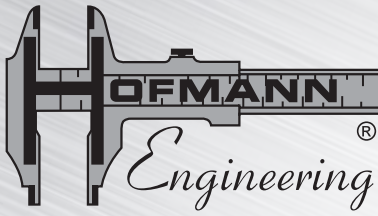

SERVING  
INDUSTRY for  
**50**  
years  
SINCE 1969

# HYDRAULIC EXCAVATOR PARTS & SERVICES

- CATERPILLAR/BUCYRUS/TEREX/O&K
- HITACHI • KOMATSU • LIEBHERR

## NEW IMPROVED SWING RACK

- AS1444 forged alloy steel ring rolled, quench & tempered to 345-375 BHN.
- Ring rolled forging offers superior mechanical properties, more homogenous grain flow in the direction of the applied principal stresses, and increased forging reduction ratio.
- Vertical tool mark striations are removed by polishing the roots to improve the fatigue life of the gear.
- Shot-peened roots to -600Mpa residual compression to improve the fatigue life of the swing gear.
- Improved cast segmented high strength alloy hub welded to the rack. Optional improvement: mechanically attached rack.

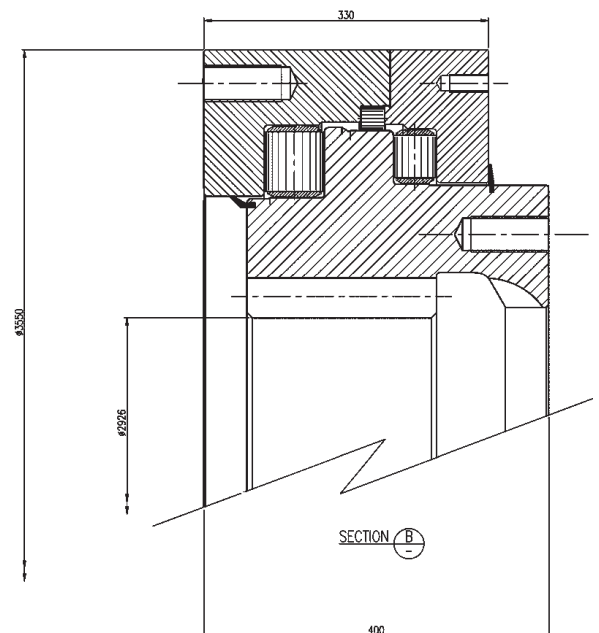
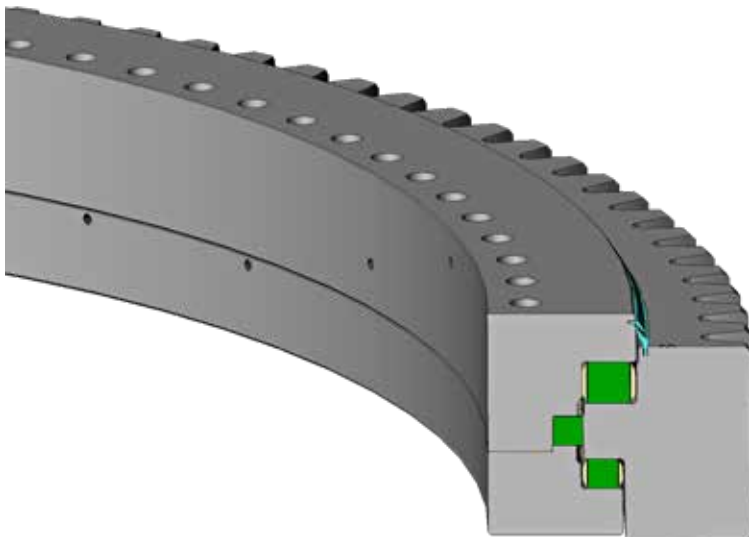
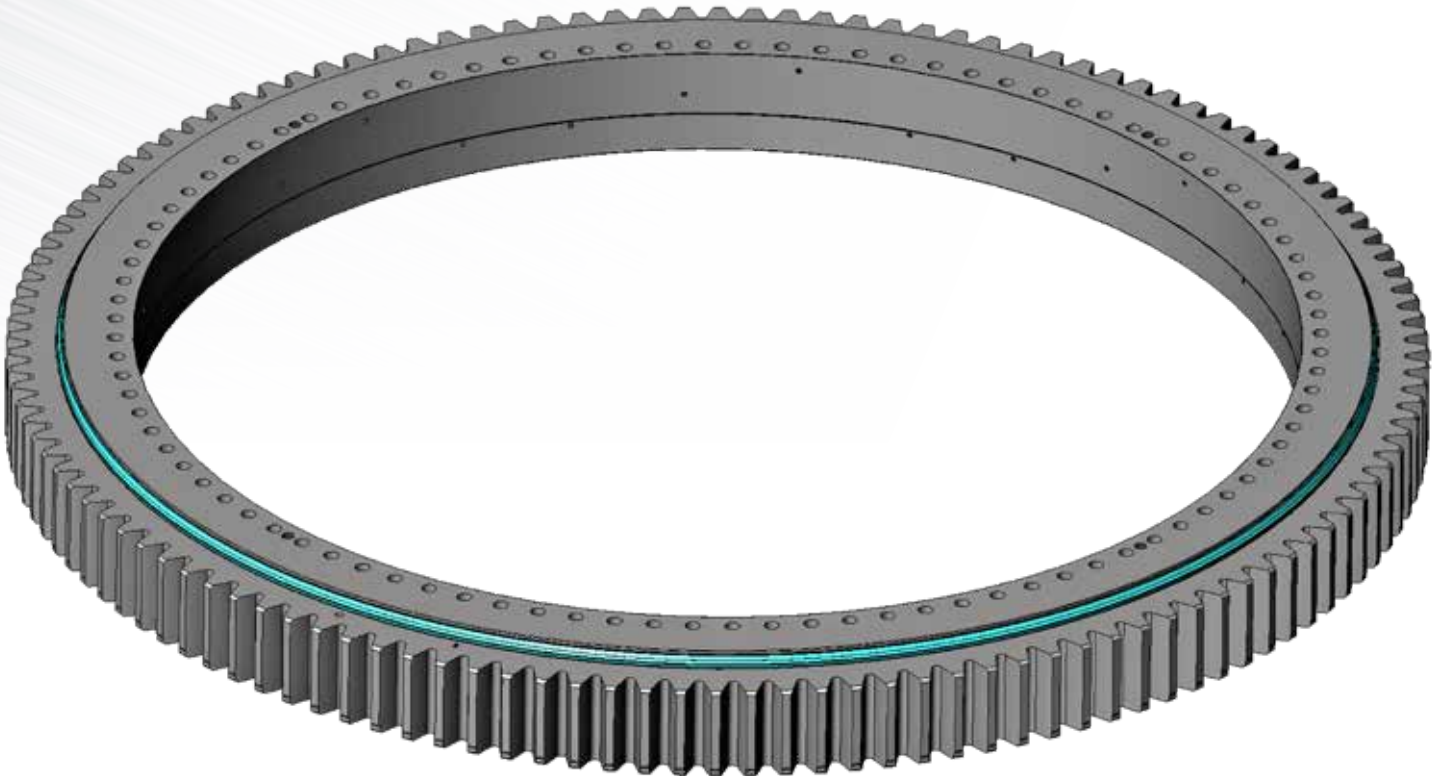

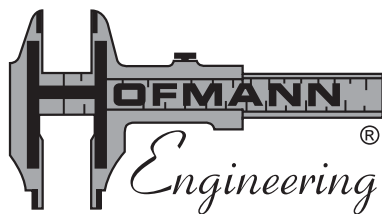

SERVING  
INDUSTRY for  
**50**  
years  
SINCE 1969

# HYDRAULIC EXCAVATOR PARTS & SERVICES

- CATERPILLAR/BUCYRUS/TEREX/O&K
- HITACHI • KOMATSU • LIEBHERR

## SIDE FRAMES

- Overhauled or fabricated new.
- Full or partial rebuilds.
- NDT inspection on repairs.
- On-site boring & welding repairs with Hofmann line boring machine.
- Pins, bushes and link replacements.
- Complete fitouts and assembly of undercarriage components, which can include final drive load roller.

### SIDE FRAME BEFORE REFURBISHMENT



### CNC MACHINING OF CRITICAL AREAS



### SIDE FRAME AFTER REFURBISHMENT



©Copyright 2019, Hofmann Engineering Pty Ltd.



## SWING TRANSMISSIONS

New or refurbished swing transmissions are available. Refurbished swing transmissions provide a cost-effective option and result in an "as new" product.



## SLEW BEARINGS

- Designed and manufactured to suit your specific requirements, or re-engineered from sample.
- Induction hardening of the bearing surfaces is carried out using the latest technology.
- Each slew bearing is supplied with full certification covering material, heat treatment and dimensional checks.



## LOAD ROLLERS, REAR & FRONT IDLERS

- **Load rollers:** forged from high alloy steel with quench and tempered core and surface hardened to 52 HRC (min) providing up to 25-30% increase in life.
- **Rear idler rollers:** forged high alloy steel quench and tempered with increase of up to 20% life.
- **Front idler:** standard or upgraded with external gearing providing up to 30% life increase.



## TRACK PADS

- Alloy steel quench and tempered.
- Induction hardened alloy steel, quench & tempered, followed by deep case induction hardening in the pin bores. Optional induction hardening on the interfacing drive and running surfaces.

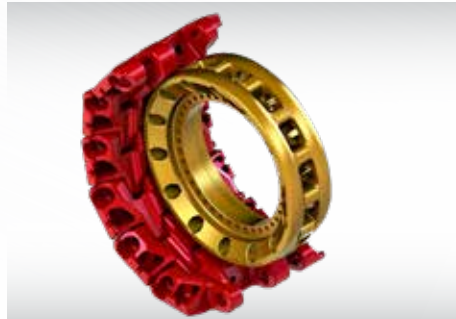

## DRIVE TUMBLERS

- Highest quality castings both metallurgically, mechanically and dimensionally.
- Precision final machining.
- A comprehensive range to suit current models.
- Quench and tempered to 400 BHN for maximum wear resistance.



## SPROCKETS

- Cast steel machined and heat treated.
- Precision final machining of sprocket teeth.
- Full range for all makes and models.



## STICKS

- Fabricated new or rebuilt to internationally recognised standards.
- Full or partial rebuilds.
- NDT inspection on repairs.
- On-site boring and welding repairs with Hofmann line boring machine.
- Pins, bushes and link replacements.
- Machined alloy racks offered as a product improvement.



## FINAL DRIVES

- Hofmann final drives are built to the highest standards using the latest material standards and heat treatment processes to achieve gear tooth hardness of 62 HRC.
- Gear geometry is optimised by the design engineers to provide maximum gear life.
- The gearing is manufactured to AGMA 12 (min). The gearing can be isotropic treated/ super finished to 0.40Ra where required. A higher surface finish reduces friction and vibration which extends the life of components.

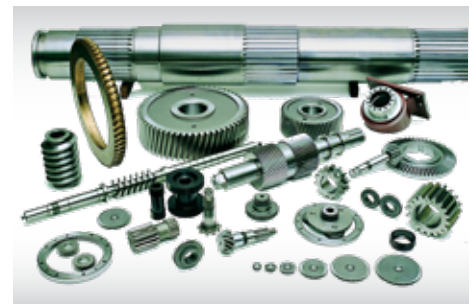

## REPLACEMENT GEARING & PARTS

- Replacement gears and components for all hydraulic excavator areas.
- Heat treatment options include through hardened, induction hardened and case carburised.
- Precision form ground or hard cut to AGMA 12 (min).

## HOFMANN ENGINEERING PTY LTD

3 Alice Street, Bassendean (Perth) Western Australia 6054 **T** +61 8 9279 5522 **F** +61 8 9279 9386 **E** mail@hofmannengineering.com

©Copyright 2019, Hofmann Engineering Pty Ltd.

**AUSTRALIA:** PERTH | MELBOURNE | BENDIGO | NEWCASTLE  
**INTERNATIONAL:** CHILE | PERU | INDIA | CHINA | NORTH AMERICA

[www.hofmannengineering.com](http://www.hofmannengineering.com)